



# Armorwire Cable Barrier Systems

The Armorwire Test Level 3 – 3 Cable Barrier and Test Level 4 – 4 Cable Barrier have been tested to the guidelines in NCHRP 350 for longitudinal cable barriers. When installed correctly the system will allow an errant vehicle to be stopped, contained or redirected in a safe manner.

## Features

- » Tested to NCHRP 350 TL3 and TL4
- » Exceptionally good vehicle control and behaviour
- » Can be used in either edge of road or median application
- » Easily installed and zero maintenance
- » Alternative foundation pile size options available
- » Easily repaired after impact
- » Designed and manufactured in New Zealand
- » Low cost patented technology

## Specifications

- » All posts are hot dip galvanised (white powdercoating optional)
- » Cable – 19mm 3 x 7 strand, pre-stretched by 35%
- » Cable heights (to the centre) as per the drawing below
- » Typically Line post footing piles are 300mm diameter x 750mm (0.05m<sup>3</sup>)
- » Length of need is met at Post 5 (Where post 1 is the trigger post)
- » Posts 2 - 5 are spaced at 2m (LoN to the trigger post)
- » The post spacing between the LoN's is 3m (unless otherwise specified)
- » Concrete to be 25mpa
- » Tensioned to 25kN at 20°C (Tension may vary depending on air temperature at time of installation, see chart)

See page 2 for dimensions and Crash Test Deflection results



Armorwire TL3 - 3 Cable Barrier



Armorwire TL4 - 4 Cable Barrier

Leading road side and barrier systems supplier

### CSP PACIFIC

306 Neilson St, Onehunga,  
PO Box 12 949, Penrose,  
Auckland 1642, New Zealand  
www.cspacific.co.nz



Columns



Multiplate



Retaining



Hire



Barriers



Traffic Control



# Armorwire Cable Barrier Systems

## Armorwire Test Level 3 – 3 cable barrier

– Cable heights (measured in mm to the centre of the cable)

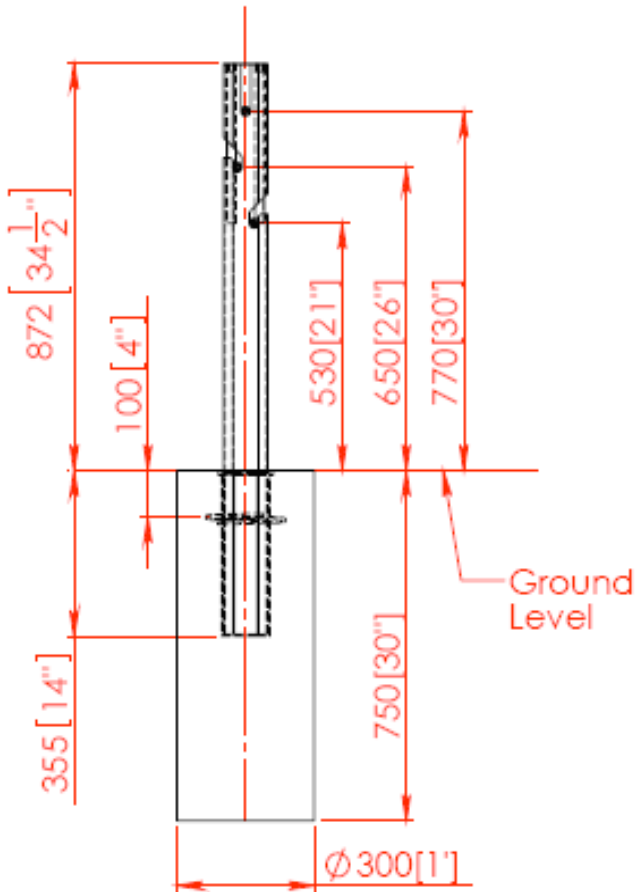

## Armorwire Test Level 4 – 4 cable barrier

– Cable heights (measured in mm to the centre of the cable)

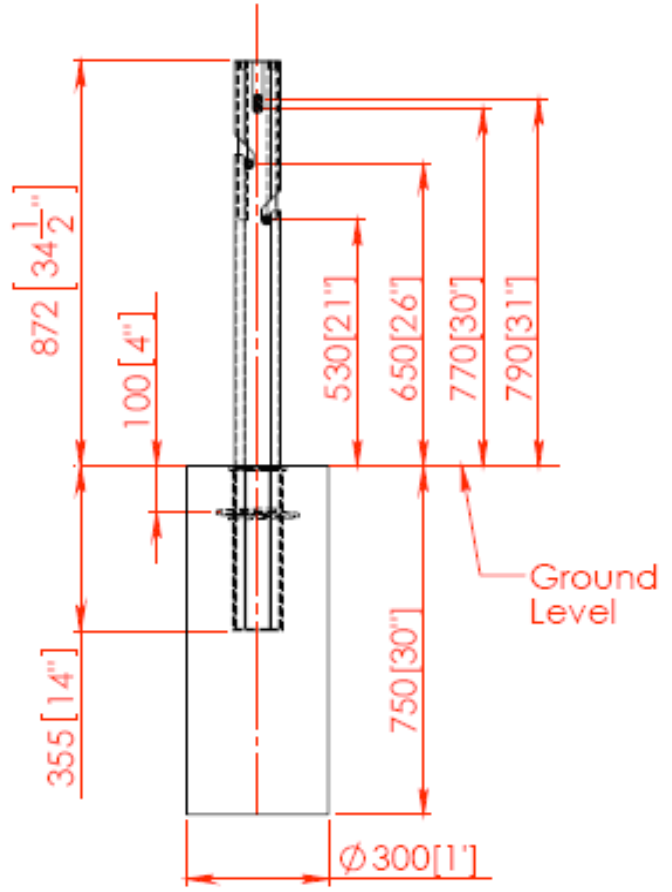

### Crash test deflection results

– test barrier length 130m

	Post spacing	Deflection
2000kg truck at 100kph at 25° angle	3.0	1.54m
8000kg truck at 80kph at 15° angle	3.0	1.10m

More information on **Armorwire Cable Barrier Systems** can be found at [www.csppacific.co.nz](http://www.csppacific.co.nz) or call **0800 655 200**

Leading road side and barrier systems supplier

#### CSP PACIFIC

306 Neilson St, Onehunga,  
PO Box 12 949, Penrose,  
Auckland 1642, New Zealand  
[www.csppacific.co.nz](http://www.csppacific.co.nz)



Columns



Multiplate



Retaining



Hire



Barriers



Traffic Control