

TYPICAL CURVED RAIL LAYOUT

DETAIL 2 SHELF ANGLE @ APEX POST
SHELF ANGLE REFER TO NOTES 6, 7 FOR DETAILS

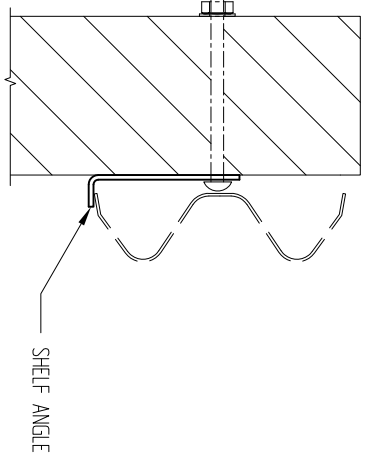

DETAIL - 1 (CABLE ANCHORED "W" SECTION)
SECTION X-X

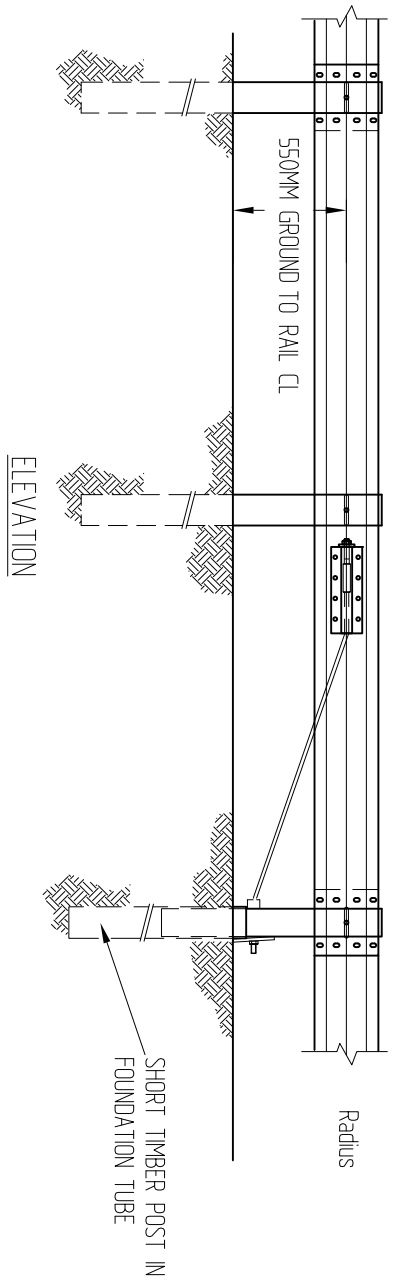

- NOTES:
1. APPROACH GRADING IS TO BE 10H: 1V OR FLATTER. MAINTAIN FREE OF OBSTRUCTIONS.
 2. A MINIMUM CLEAR AREA OF 22M X 6M TO BE PROVIDED BEHIND THE GUARDRAIL.
 3. CLEAR AREA BEHIND GUARDRAIL TO BE 6H: 1V OR FLATTER AND MAINTAINED FREE OF OBSTRUCTIONS
 4. NO WASHERS ARE TO BE USED WITH THE MUSHROOM HEAD BOLTS ON FACE OF RAIL.
 5. THE LOCATIONS OF THE 3 APEX POSTS WILL DEPEND ON MOST LIKELY IMPACT DIRECTIONS.
 6. RAIL ON SHELF ANGLE AT CURVE APEX. NO BOLT THROUGH RAIL.
 7. NO BLOCKOUTS ON APEX POSTS.

No.	Revision	Date	Approved	Date
			JC	10/13
			Endorsed	Date
			FT	10/13

Series	Title
ROAD SAFETY BARRIERS	RAIL ON CURVE TL3 STRONG POST TIMBER

Ref./Number	Rev.
RSB-2A	2