

NOTES UNLESS OTHERWISE SPECIFIED.

1. X-TENUATOR TO BE INSTALLED AS PER MANUFACTURER'S INSTRUCTIONS.
2. ITEMS # 17, 42 & 43 NOT SHOWN

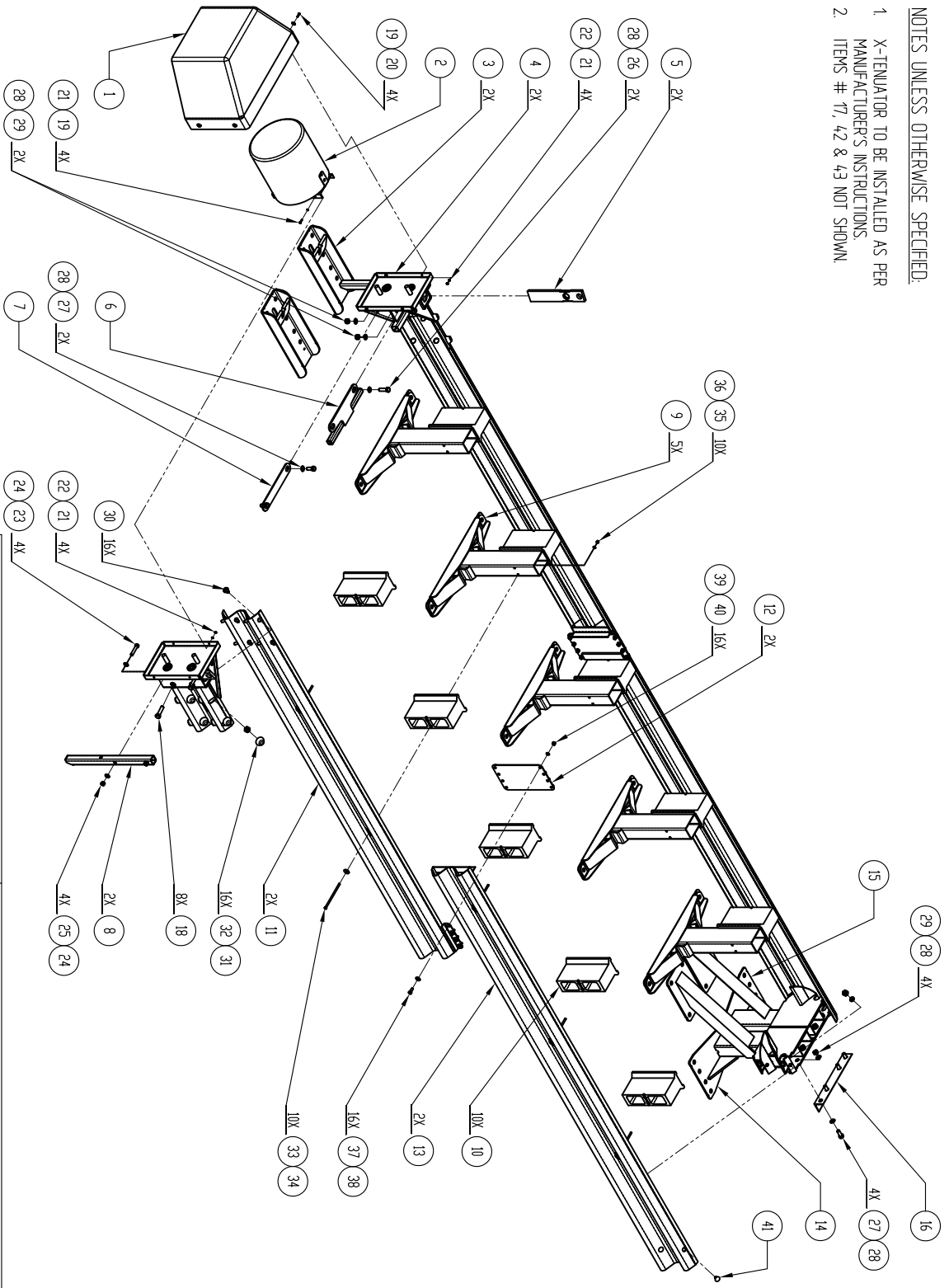

Find No.	Quantity per	Description
1	1	Nose Cover, X-TENUATOR
2	1	EA Nose Carriage, X-TENUATOR
3	2	Cable Anchor Weldment
4	2	Head Unit Weldment, X350
5	2	Cable Friction Plate
6	1	Upper Head Support Weldment
7	1	Lower Head Support Plate
8	2	Head Support Leg Weldment
9	5	Leaning Post Weldment
10	10	W-Beam Composite Blockout 8in
11	2	Front Panel Weldment
12	2	Slider Brace Weldment, Front
13	2	Back Panel Weldment
14	1	Backstop Weldment, Right
15	1	Backstop Weldment, Left
16	1	Brace, Backstop, X-TENUATOR
17	2	Cable Assembly, X-TENUATOR
18	8	C-Scr HH M20-2.5x75mm Gr. 5.8
19	10	C-Scr HH M6-1x26mm Mgal
20	6	Wshr M6 OD 38x1.6 Thick
21	14	Wshr M6 Mgal Class 6
22	10	Nut HN M6-1 Mgal Class 6
23	4	C-Scr HH W8-1.25x230mm Mgal
24	8	Wshr W8 Mgal Class 8
25	4	Nut HN W8-1.25 Mgal Class 8
26	2	C-Scr HH M20-2.5x65mm Mgal
27	6	C-Scr HH M20-2.5x60mm Mgal
28	16	Wshr M20 Mgal Class 8
29	8	Nut HN M20-2.5 Mgal Class 8
30	16	Guardrail Bolt M16x32
31	16	Guardrail Nut Recessed M16
32	16	PLASTIC NUT PROTECTOR
33	10	C-Scr HH M12-1.75x32mm Mgal
34	10	Wshr SL M12 Mgal Class 8
35	15	Wshr SL M12 Mgal Class 8
36	15	Nut HN M12-1.75 Mgal Class 8
37	16	C-Scr HH M16-2.5x83mm Mgal
38	16	Wshr SL M12 Mgal Class 8
39	16	Wshr SL M12 Mgal Class 8
40	16	Nut HN M12-1.75 Mgal Class 8
41	1	Kit, X-Tension Shear Bolt
42	1	Tether Kit, X-TENUATOR
43	2	Cable Tie 15x1/4 dia UV Bk



**CSP PACIFIC**  
 306 Neilson Street,  
 Onehunga, Auckland  
 PO Box 12 949, Pentose  
 Auckland, New Zealand  
 Telephone 09-634 1239  
 Facsimile 09-634 4525  
 www.cspacific.co.nz

X-TENUATOR  
 100kph NARROW  
 AF/BSI Reference Dwg No. XTEN100N  
 SHEET 1 OF 4

Drawn by	SB	Date	19/05/11
Checked	--	Scale	A4
Reference No.			NTS
Drawing no.	FX584-1		Rev No.
			1